

176 yds. = 176 yds.
 + d. 17° w. s. ch. = 3 1/4 yds.
 = 660 yds.
 + d. 48° w. 17 ch. = 660 yds.
 = 1210 yds. w. s. ch.

1320
 132
 1452

[p.u]

150
 22
 172
 22
 194

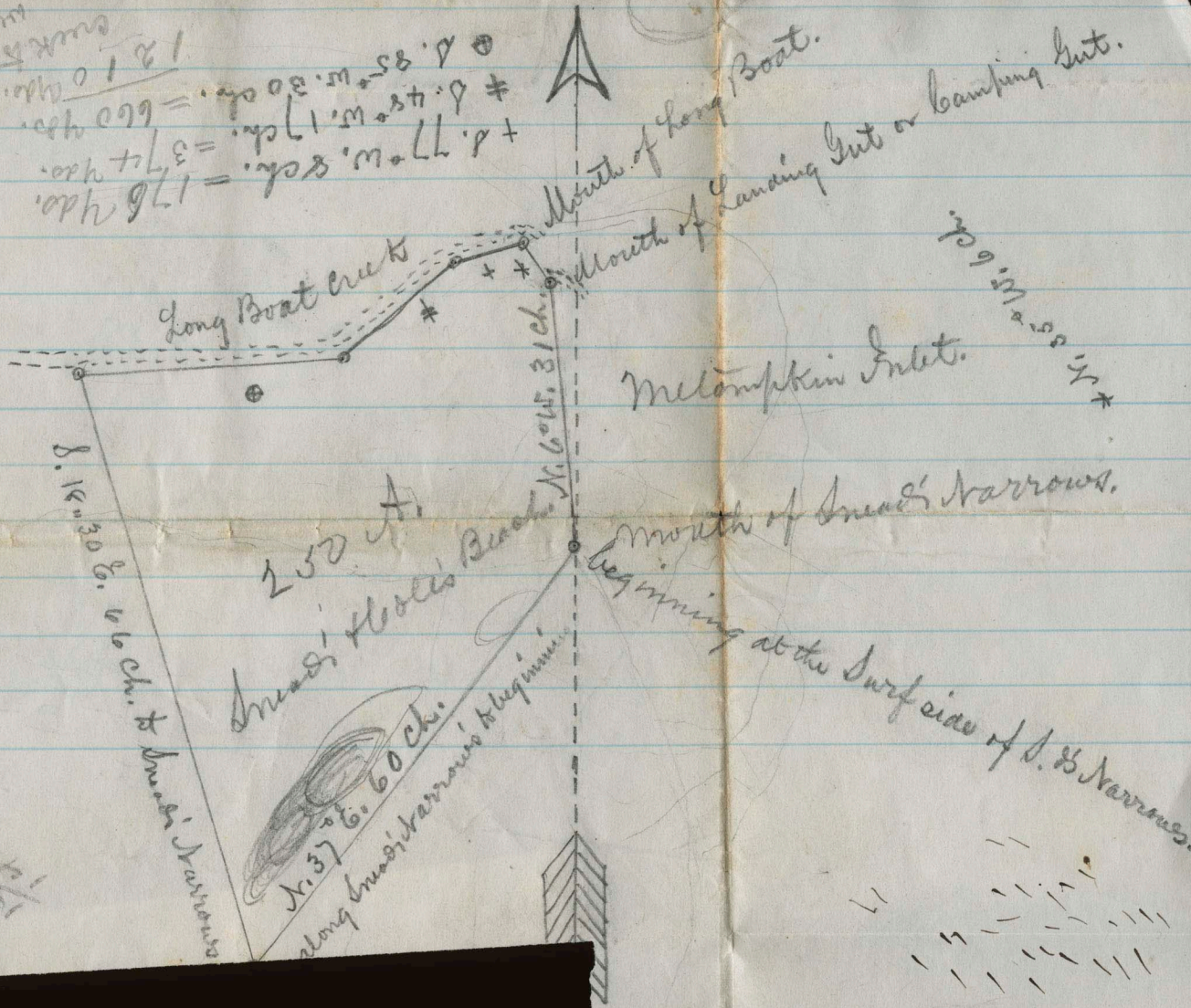

+ d. 85° w. s. ch. #
 + d. 48° w. 17 ch. #
 + d. 17° w. s. ch. +

Long Boat Creek

Mouth of Long Boat

Metompink Inlet.

Mouth of Small Narrows.

Beginning at the Surf side of S. S. Narrows.

250 A.

Small Host's Beach

N. 37° 6. 60 ch. along Small Narrows to beginning.

8.14° 30 E. 66 ch. to Small Narrows

39° 32' 20" W